

# PRODUCTION WAREHOUSE COMPLEX



BY ADDRESS: PRIMYSKA STREET, POGREBY  
VILLAGE, BROVARSKY DISTRICT, KYIV  
REGION

[Click - GPS](#)

## **PLOT AREAS**

15, 19, 19, 23 acres

## **AREAS OF WAREHOUSES (INCLUDING OFFICE PREMISES)**

3x842 м<sup>2</sup> and 1x1132 м<sup>2</sup>

## **WAREHOUSE SIZES**

3(42x18) та 1(42x24)

## **POWER OF THE OBJECT**

860 and 1266 pallet seats

## **ELECTRICITY**

50 kilowatt (for one warehouse)

*Possibility of installing canopies between warehouse, which will significantly increase storage area.*





# Why choose CD4U?

- 1 Qualitatively built warehouses
- 2 Durability and reliability
- 3 Easy transport connection with Kyiv, only 1.6 km to the capital
- 4 Aesthetics
- 5 Security





# GENERAL LAYOUT

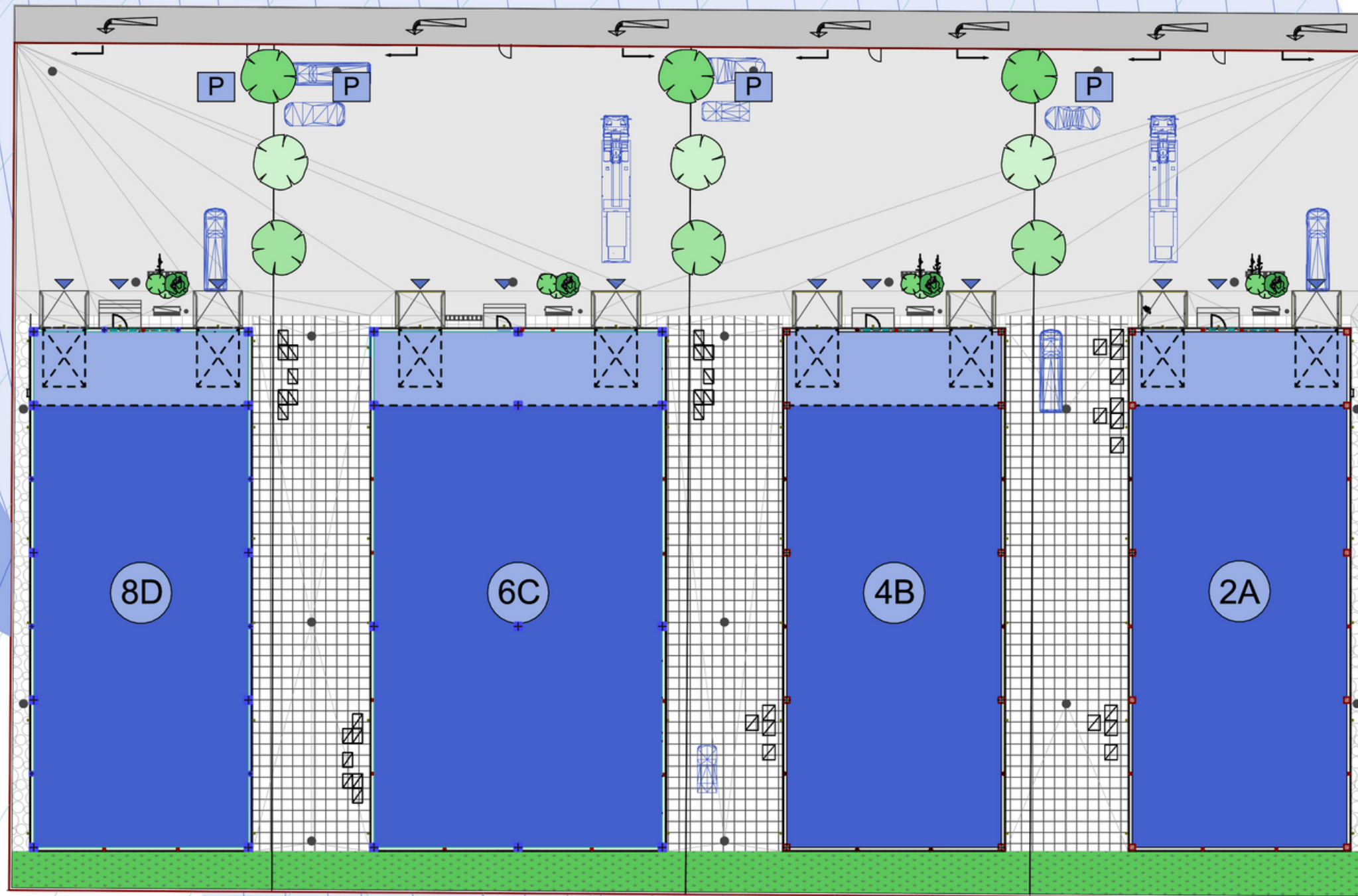

вул. Приміська

проект Кільцева Погр.

вул. Погребський шлях

до м. Києва



## AREA OF STORAGE FACILITIES

755 m<sup>2</sup>

## AREA OF OFFICE PREMISES

74 m<sup>2</sup>

## TECHNICAL ROOM

13 m<sup>2</sup>

## FLOORS (MEZZANINE):

1(2)

## GATE

2pcs.

## POWER

860 pallet seats

## AREA OF PLOTS

15;19;19 acres

# PLANNING- 842m<sup>2</sup>

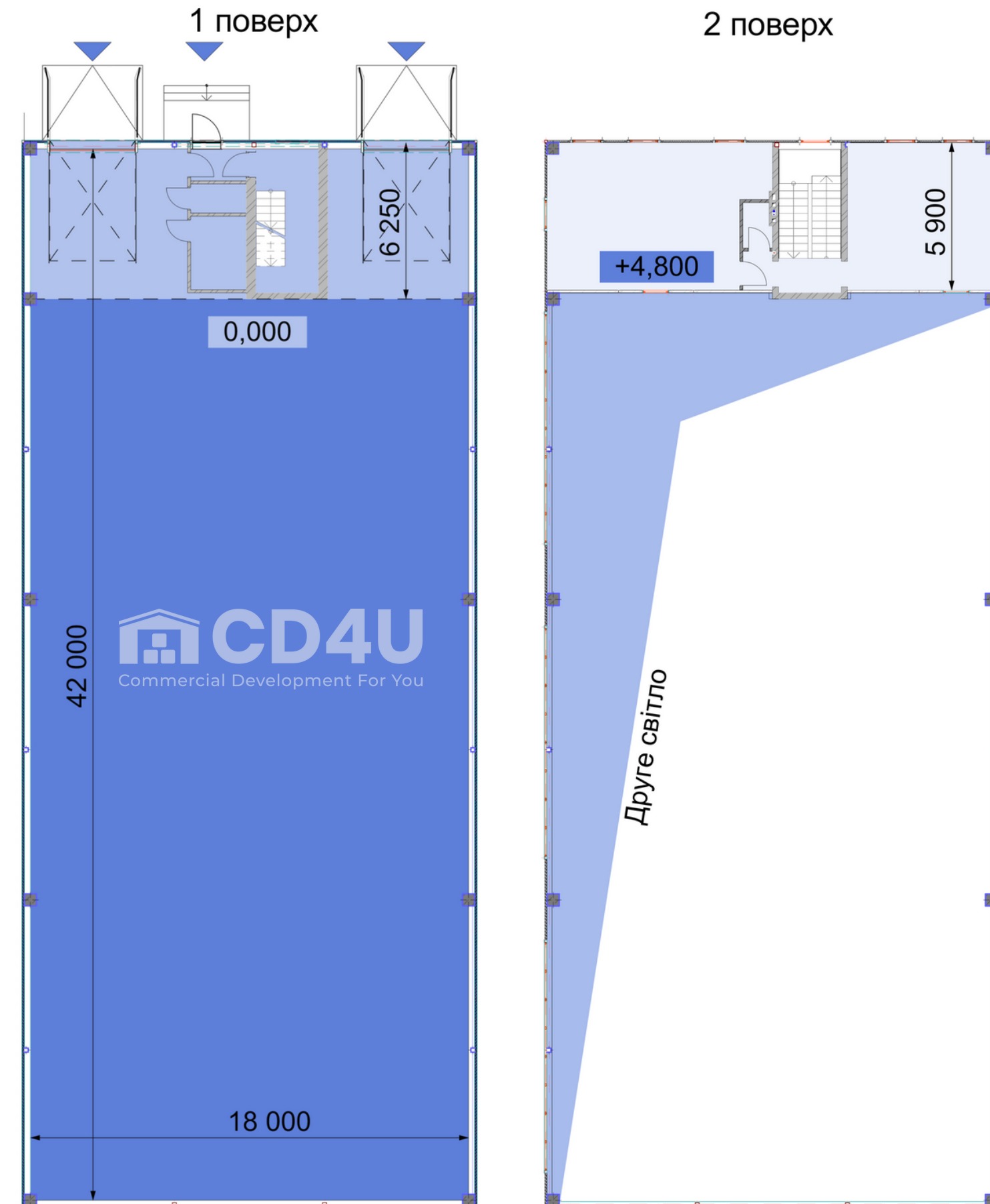



## AREA OF STORAGE FACILITIES

1009 m<sup>2</sup>

## AREA OF OFFICE PREMISES

110 m<sup>2</sup>

## TECHNICAL ROOM

13 m<sup>2</sup>

## FLOORS (MEZZANINE):

1(2)

## GATE

2 pcs.

## POWER

1266 pallet seats

## AREA OF PLOTS

23 acres

# PLANNING- 1132m<sup>2</sup>

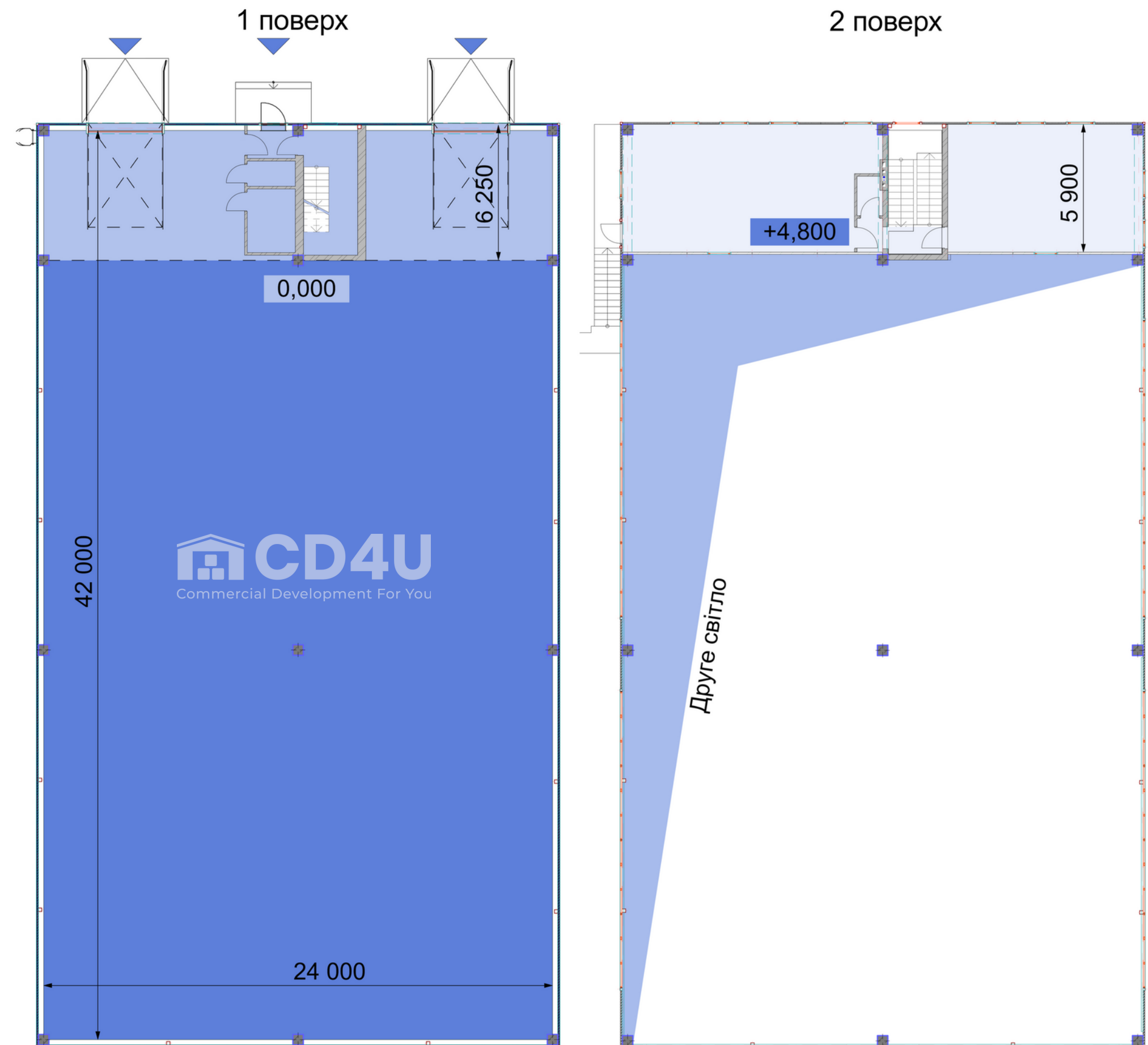



# SECTION

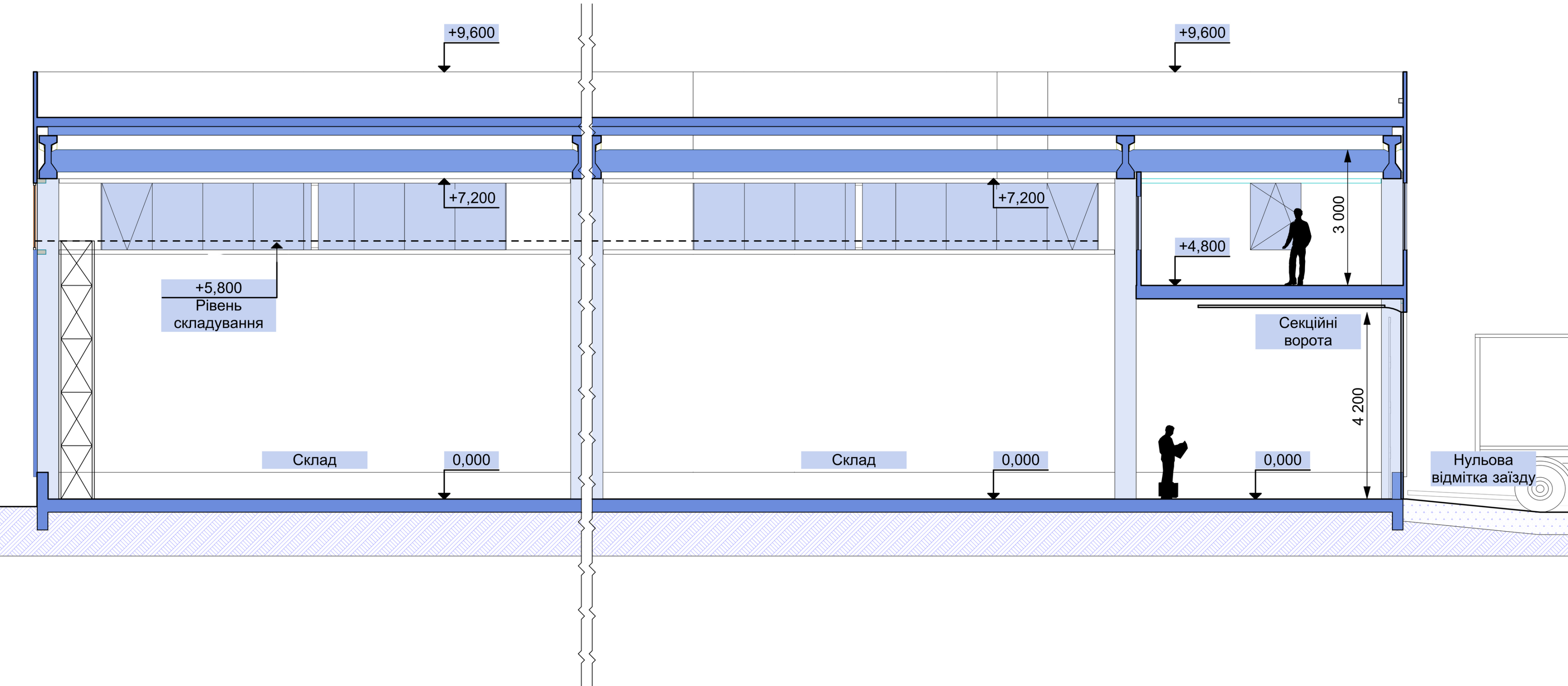



# CHARACTERISTICS

## WAREHOUSE

1	Column grid	12x18, 12x24
2	Height of the warehouse	7,2 м. to the bottom of the beam
3	Frame	Precast concrete
4	Outside walls	Sandwich panels – 80мм. PIR
5	Roofing	PVC membrane, 150 мм mineral wool
6	Floor	Industrial with topping (under load 5т/м2)
7	Gate	Modular, insulated with electric shutters (4,1x3,42)
8	Windows	Double-glazed windows with an electric drive (REHAU)
9	Entrance door	External, metal, insulated

## MEZZANINE

1	Level	At the level of 4.8m from the floor of production premises
2	Floor	For finishing
3	Internal partitions	Aerased concrete, red brick
4	Windows	Metal-plastic with two-chamber double glazed windows and a five-chamber profile (REHAU)
5	Stairs	Concrete, 3x flights
6	Heating	Electrical

## COMMUNICATIONS

1	Electricity supply	50 kilowatt, 3 phases (for each composition)
2	Water supply	Own well (for each warehouse)
3	Facade lighting	Three sides
4	Fire protection system	According to regulatory documents